

FORM No. 1.

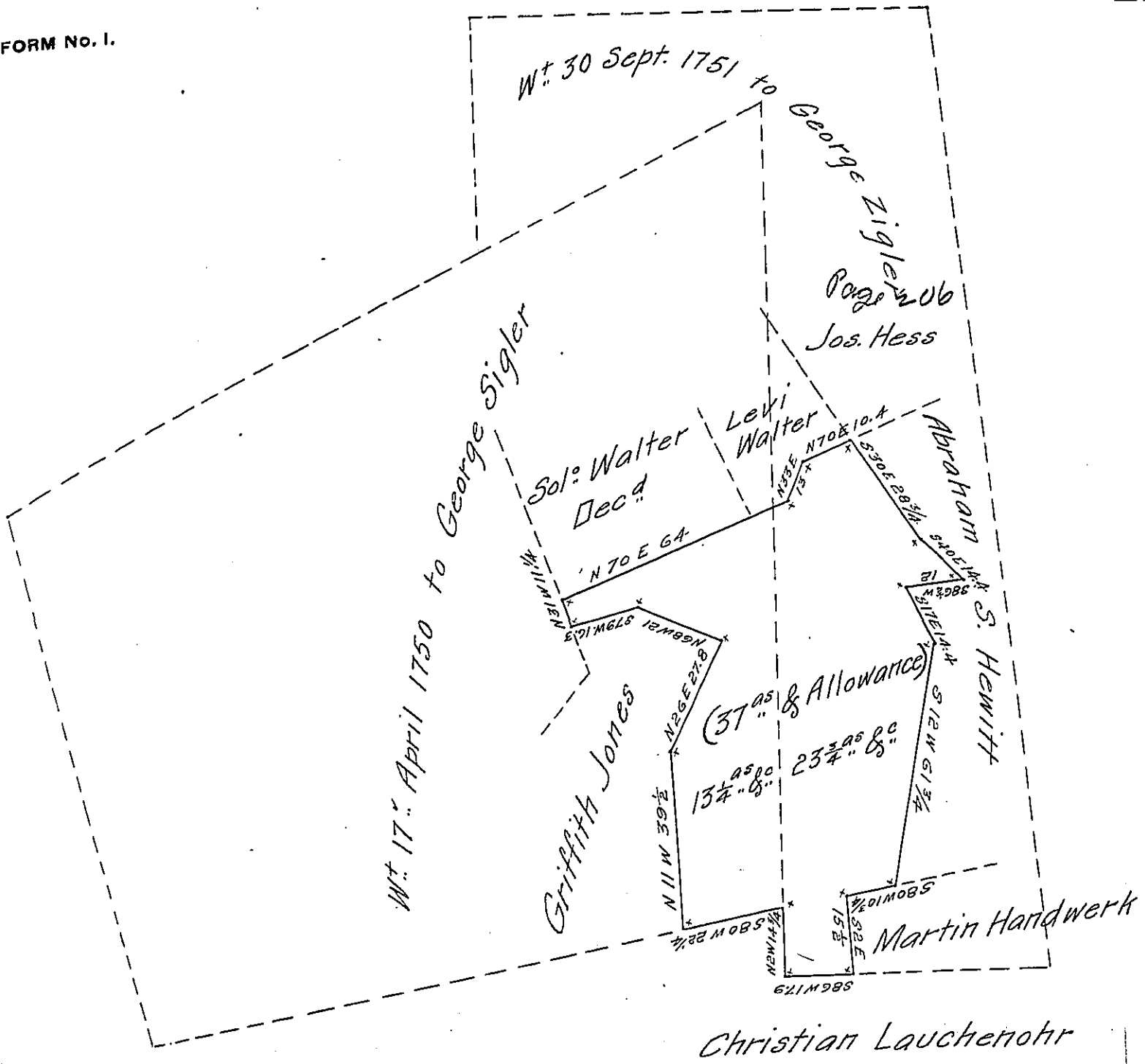

Draft of a tract of land situate in Heidelberg township, Lehigh County, Containing 37 acres and allowance of six per cent for roads &c. Returned for Charles Engel and being parts of two larger tracts originally surveyed to George Ziegler or Sigler dated April 17<sup>th</sup> 1750 and Sept. 30<sup>th</sup> 1751 respectively.

13 1/4<sup>acs</sup> &c. part of Wt. 17 April 1750  
 23 3/4<sup>acs</sup> &c. " " " 30 Sept. 1751

Geo. Blank C.S.

To R. B. Beath Esq.  
 Surveyor General.

IN TESTIMONY that the above is a copy of the original remaining on file in the Department of Internal Affairs of Pennsylvania, made conformably to an Act of Assembly approved the 16th day of February, 1833, I have hereunto set my Hand and caused the Seal of said Department to be affixed at Harrisburg, this twenty-ninth day of October 1906

*Isaac R. Pearson*  
 Secretary of Internal Affairs.